

**MODEL:** iR2200i & iR3300i

**SUBJECT:** Launch of Models to the UK Marketplace

**Detail:**

<Overview >

The iR2200i and iR3300i models have now been launched by Canon UK Ltd and are essentially, 'intelligent' updates of the existing iR2200, 2800 and 3300 products.

**Please note that there is no iR2800i**

The purpose of this ATI is to cover the main hardware differences between the current iR (Image Runner) products and the new iRi (Intelligent) models. The iR2200i and iR3300i models come in 2 boxes. The main body of the machine in one box and the scanner assembly, with DADF-H1 already attached, in the other. Fitting these two units together is fairly straightforward, however, care must be exercised when lifting the scanner assembly – B1. This is due to the weight and the bulky nature of the product. These products are supplied with DADF-H1, Printer Board Kit C1 and Super G3 Fax Board-J1 as standard. The most obvious visual difference is the larger colour LCD touch screen.



## &lt; Installation &gt;

The procedure for this can be found as a separate file, stored with this ATI on Notes/Intranet/Dealernet under Product Technical Bulletins.

*Filename iR2200i install pro.pdf*

## &lt; Training &gt;

No additional hardware technical training will be necessary due to the similarity with the earlier iR2200 Series. The 'intelligent' features are covered by the IPO (Intelligent Product Overview) course and is targeted at the Systems Technicians

## &lt; Consumables &gt;

The iR2200i and iR3300i use the same drum and toner as the earlier products. The MSDS database and CE Certifications have been updated.

## &lt; Spare Parts &gt;

The Parts Catalogue is available on microfiche, part number FY8-31FV-F000, or on the iR2200 Series compilation CD Rom, part number CD-iR2200-01Z.

See attached pages for the Specification :-

## 1 Specifications

### 1.1 Main Body

#### 1.1.1 Type

Item	Description
Body	Desktop
Copyboard	Fixed
Light source	Xenon lamp
Lens	Lens array
Photosensitive medium	OPC drum (30-mm dia.)

#### 1.1.2 Systems

Item	Description
Reproduction	Indirect electrostatic
Charging	AC roller
Exposure	Laser
Copy density adjustment	Auto or manual
Development	Single-component toner projection
Pickup	Auto
	Front cassette (2 cassettes)
	Retard method (about 500 sheets of 80 g/m <sup>2</sup> paper, about 550 sheets of 64 g/m <sup>2</sup> paper)
	Manual
	Multifeeder
	Dual process method (about 50 sheets of 80 g/m <sup>2</sup> paper)
Transfer	Roller
Separation	Static eliminator (static separation) + curvature
Cleaning	Blade
Fixing	SURF method (plane heater and fixing film)

### 1.1.3 Functions

Item		Description
Resolution	Reading	600dpi×600dpi
	Copying	1200dpi×600dpi
	Printer output	2400dpi×600dpi
Original type		Sheet, book 3-D object (2 kg max.)
Maximum original size		A3/279.4×431.8mm (11"×17")
Reproduction ratio		Direct (1:1), Reduce I (1:0.250), Reduce II (1:0.500), Reduce III (1:0.611), Reduce IV (1:0.707), Reduce V (1:1.414), Enlarge IV (1:2.000), Enlarge V (1:4.000), Enlarge VI (1:8.000), Zoom (1:0.250 to 8.000 ; 25% to 800% in 1% increments)
Wait time		10 sec or less (at 20°C/168°F)
First copy time		5.8 sec (book mode, cassette 1, Direct, A4/LTR, text mode)
Continuous copying		999 copies max.
Copy size		
Cassette	A/B	A3 max., A5 (vertical feed) min.
	Inch	279.4×431.8 mm (11"×17") max., STMT (vertical feed) min.
Manual feed	AB	A3 max., postcard (vertical feed) min.
	Inch	279.4×431.8 mm (11"×17") max., STMT (vertical feed) min.
Cassette 1/2		<ul style="list-style-type: none"> <li>• Plain paper (64 to 80 g/m<sup>2</sup>):A3, B4, A4, B5, A5R, A4R, B5R, 279.4×431.8mm (11"×17"), LGL, LTR, LTRR, STMT, STMTR</li> <li>• Tracing paper (SM-1):A3, B4, A4, B5, A4R, B5R</li> <li>• Colored paper (Canon-recommended):B4, A4, A4R</li> </ul>
Multifeeder		<ul style="list-style-type: none"> <li>• Plain paper (64 to 80 g/m<sup>2</sup>):A3, B4, A4, B5, A5R, A4R, B5R, 279.4×431.8mm (11"×17"), LGL, LTR, LTRR, STMT, STMTR</li> <li>• Tracing paper (SM-1, GSN-75):A3, B4, A4, B5, A4R, B5R</li> <li>• Transparency (Canon-recommended):A4, A4R, LTR, LTRR</li> <li>• Colored paper (Canon-recommended):B4, A4, A4R</li> <li>• Postcard: Jpn (vertical feed), double-card, 4-sheet card</li> <li>• Label sheet (Canon-recommended):B4, A4, A4R, LTR, LTRR</li> <li>• Thick paper (90 to 128 g/m<sup>2</sup>):A3, B4, A4, B5, A4R, B5R, LTR, LTRR</li> <li>• Envelope</li> </ul>

Item	Description
Single-sided copying mode	<ul style="list-style-type: none"> <li>• Plain paper (64 to 80 g/m<sup>2</sup>):A3, B4, A4, B5, A5R, A4R, B5R, A5, 279.4×431.5mm (11"×17"), LGL, LTR, LTRR, STMT, STMTR</li> <li>• Tracing paper (SM-1, GSN-75):A3, B4, A4, B5, A4R, B5R</li> <li>• Transparency (Canon-recommended):A4, A4R, LTR, LTRR</li> <li>• Colored paper (Canon-recommended):B4, A4, A4R</li> <li>• Postcard: Jpn postcard (vertical feed), double-card, 4-sheet card</li> <li>• Label sheet (Canon-recommended):B4, A4, A4R, LTR, LTRR</li> <li>• Thick paper (90 to 128 g/m<sup>2</sup>):A3, B4, A4, B5, A4R, B5R, LTR, LTRR</li> <li>• Envelope</li> </ul>
Double-sided copying mode (automatic)	<ul style="list-style-type: none"> <li>• Plain paper (64 to 80 g/m<sup>2</sup>):A3, B4, A4, B5, A5R, A4R, B5R, 279.4×431.8mm (11"×17"), LGL, LTR, LTRR, STMT, STMTR</li> <li>• Colored paper (Canon-recommended):B4, A4, A4R</li> </ul>
Double-sided copying mode (multifeeder)	<ul style="list-style-type: none"> <li>• Plain paper (64 to 80 g/m<sup>2</sup>):A3, B4, A4, B5, A5R, A4R, B5R, 279.4×431.8mm (11"×17"), LGL, LTR, LTRR, STMT, STMTR</li> <li>• Colored paper (Canon-recommended):B4, A4, A4R</li> <li>• Postcard: Jpn (vertical feed), double-card, 4-sheet card</li> <li>• Thick paper (90 to 128 g/m<sup>2</sup>):A3, B4, A4, B5, A4R, B5R, LTR, LTRR</li> </ul>

Item	Description	
Cassette	Capacity	55 mm deep (approx.; about 500 sheets of 80 g/m <sup>2</sup> paper)
Hard disk		6GB
Non-image width	Leading edge	Direct, Enlarge/Reduce:4.0±1.5/-1.0mm <4.5±1.8mm>*1
	Trailing edge	Direct, Enlarge/Reduce:2.0±1.5mm <2.0±1.8mm>*1
	Left/right (1st side)	Direct, Enlarge/Reduce:2.5±1.5mm <2.5±2.0mm>*1
Auto clear		Yes (2 min standard; may be changed in 1-min increments between 0 and 9 min)
Sleep mode		Yes (2 min standard; may be changed in user mode to 10sec, 1, 2, 10, 15, 20, 30, 40, 50, 60, 90 min, 2, 3, or 4 hr)
Accessory		<ul style="list-style-type: none"> <li>• DADF-H1 *2</li> <li>• Platen Cover TypeE</li> <li>• Document Tray-D2</li> <li>• Copy Tray-F1</li> <li>• Saddle Finisher-G1</li> <li>• Puncher Unit-K1 (2/3holes), G1/H1 (4holes)</li> <li>• Finisher-J1</li> <li>• Inner 2Way Tray-A1</li> <li>• Paper Deck-L1</li> <li>• Cassette Feeding Unit-W1</li> <li>• Card Reader-C1</li> <li>• Network Multi-PDL Printer Kit-C1 *2</li> <li>• Token Ring Network Interface Adapter iN-TR2</li> <li>• Supper G3 FAX Board-J1 *2</li> </ul>

\*1:The values within parentheses indicate when the DADF is used.

\*2:Accessory for iR2200/iR2800/iR3300.

The above specifications are subject to change for product improvement.

## 1.1.4 Others

Item	Description	
Operating environment	Temperature range	15° to 30°C/59 to 86°F
	Humidity range	5 to 80%
	Atmospheric pressure	810.6 to 1013.3 hpa (0.8 to 1.0 atm)
Power consumption	Maximum	1350W or less
	Standby	48 W (approx.; reference only)
	Continuous	720 W (approx.; reference only)
Noise	Sound power level (Impulse mode)	
	Copying	iR2200/iR2200i/iR2800/iR2800i: 66 dB or less iR3300/iR3300i: 71 dB or less
	Standby	iR2200/iR2200i/iR2800/iR2800i: 40 dB or less iR3300/iR3300i: 50 dB or less
Ozone	0.01 ppm or less avg., 0.02 ppm or less max.	
Dimensions	iR2200/iR2800/iR3300:	
	565 (W) × 678 (D) × 1020 (H) mm*	
	Image Reader-B1+iR2200i/iR2800i/iR3300i:	
	565 (W) × 762(D) × 1040 (H) mm*	
	(Image Reader-B1:	
	565 (W) × 579(D) × 106 (H) mm)	
Weight	(iR2200i/iR2800i/iR3300i:	
	565 (W) × 678 (D) × 1000 (H) mm*)	
	*With Cassette Feeding Unit-W1	
	iR2200/iR2800/iR3300:	
	80 kg (approx.)/176.3 lb (approx.)	
	Image Reader-B1:	
Consumables	13.5 kg (approx.)/29.8 lb (approx.)	
	iR2200i/iR2800i/iR3300i:	
	76.5 kg (approx.)/168.7 lb (approx.)	
	Keep wrapped to protect against humidity.	
	Keep away from direct sunshine, and keep at	
	40°C/85% or less.	
Toner	Copy paper	

Reproduction mode	Side	Paper size	copies /min (1-to-N)		
			iR2200	iR2800	iR3300
Direct	A3 (297×420mm)	A3	16	16	16
	A4 (210×297mm)	A4	22	28	33
	A5 (149×210mm)	A5	18	18	18
	B4 (257×364mm)	B4	14	14	14
	B5 (182×257mm)	B5	28	28	28
	A4R (297×210mm)	A4R	18	18	18
	B5R (257×182mm)	B5R	18	18	18
	A5R (210×149mm)	A5R	18	18	18
Reduce II (50.0%)	A3 → A5R	A5R	18	18	18
	III (61.1%)	A3 → B5R	18	18	18
	IV (70.7%)	B4 → B5R	18	18	18
	V (81.6%)	A3 → A4R	18	18	18
		B4 → A4R	18	18	18
	VI (86.5%)	B5R → A5R	18	18	18
		A4 → B5	28	28	28
		A3 → B4	14	14	14
Enlarge IV (200.0%)	A5R → A3	A3	16	16	16
	III (141.4%)	A4R → A3	16	16	16
	II (122.4%)	B5R → B4	14	14	14
		A4R → B4	14	14	14
	I (115.4%)	A5 → B5	28	28	28
		B4 → A3	16	16	16
		B5 → A4	22	28	33

Delivery by copier, Auto paper select ON, Auto density, Non-sort, Cassette

Reproduction mode	Size		(1toN)		
			iR2200	iR2800	iR3300
Direct	279.4×431.8mm	279.4×431.8mm	16	16	16
	(11"×17")	(11"×17")			
	LTR	LTR	22	28	33
	LGL	LGL	14	14	14
	LTRR	LTRR	18	18	18
	STMTR	STMTR	18	18	18
Reduce II (50.0%)	279.4×431.8mm	STMTR	18	18	18
	(11"×17") → STMTR				
	III	LTRR	18	18	18
	(64.7%)	(11"×17") → LTRR			
	IV	LGL	14	14	14
(73.3%)	(11"×17") → LGL				
	V	LTRR	18	18	18
(78.6%)	LGL → LTRR				
Enlarge IV (200.0%)	STMTR* →	279.4×431.8mm	16	16	16
	279.4×431.8mm	(11"×17")			
	(11"×17")				
	III	LTRR →	16	16	16
	(129.4%)	279.4×431.8mm			
	(11"×17")				
	II	LGL →	16	16	16
(121.4%)	279.4×431.8mm	(11"×17")			
	(11"×17")				
	Paper size	copies/min			

\*STMTR cannot be used as an original.

Delivery by copier, Auto paper select ON, Auto density, Non-sort, Cassette

The above specifications are subject to change for product improvement.

## 1.2 Side Paper Deck-L1

Item	Description
Pickup method	Retard
Paper accommodation	Front loading
Paper type (horizontal feed only)	Plain paper (65 to 80 g/m <sup>2</sup> ): A4, B5, LTR Colored paper (Canon-recommended): A4
Capacity	2,500 sheets (approx.; 80 g/m <sup>2</sup> paper)
Paper size switch	By size guide plate/in service mode
Dimensions	324 (W) × 591 (D) × 432 (H) mm 12.8 (W) × 23.3 (D) × 17.0 (H) in
Weight	30 kg (approx.)/66.1 lb (approx.)
Power supply	None (DC power supplied by accessories power supply of host machine)
Operating conditions	Same as host machine

The above specifications are subject to change for product improvement.

## 2 Names of Parts

### 2.1 External View

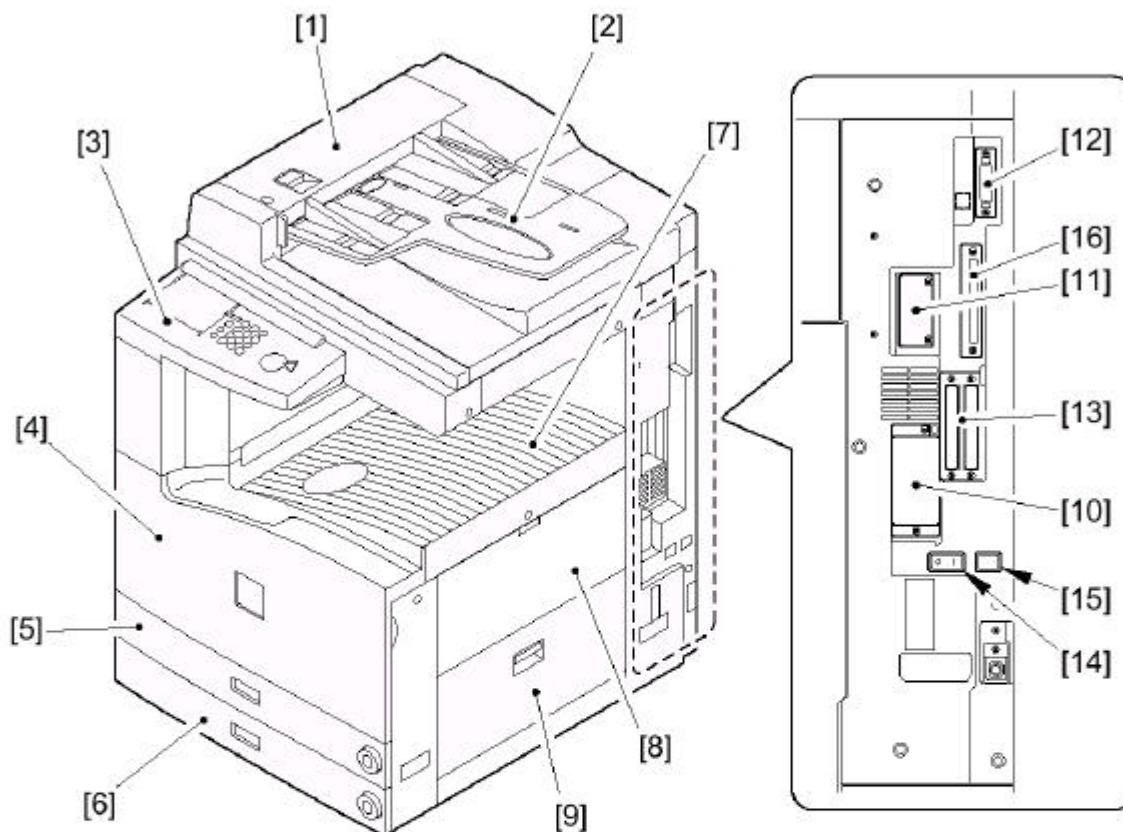

- [1] ADF
- [2] Original tray
- [3] Control panel
- [4] Front cover
- [5] Cassette 1
- [6] Cassette 2
- [7] Delivery tray
- [8] Multifeeder

- [9] Right lower cover
- [10] DIMM ROM replacement cover
- [11] Network card slot
- [12] Parallel connector
- [13] Extension board slot
- [14] Main power switch
- [15] Cassette heater switch
- [16] I/F cable connector\*

\*iR2200i/iR2800i/iR3300i only.

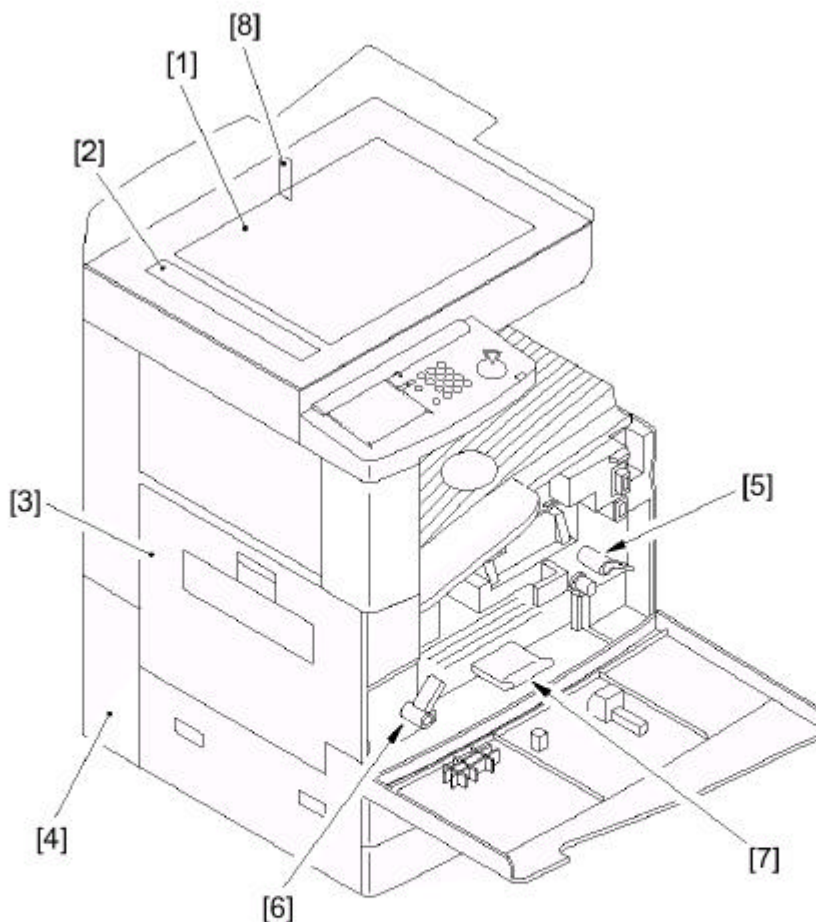

- [1] Copyboard glass
- [2] DADF reading glass
- [3] Left cover
- [4] Left lower rear cover (waste toner case cover)

- [5] Developing assembly releasing lever
- [6] Feeding assembly releasing lever
- [7] Duplex feeding assembly releasing lever
- [8] I/F cable connector\*

\*Image Reader-B1 only.

## 2.2 Cross Section

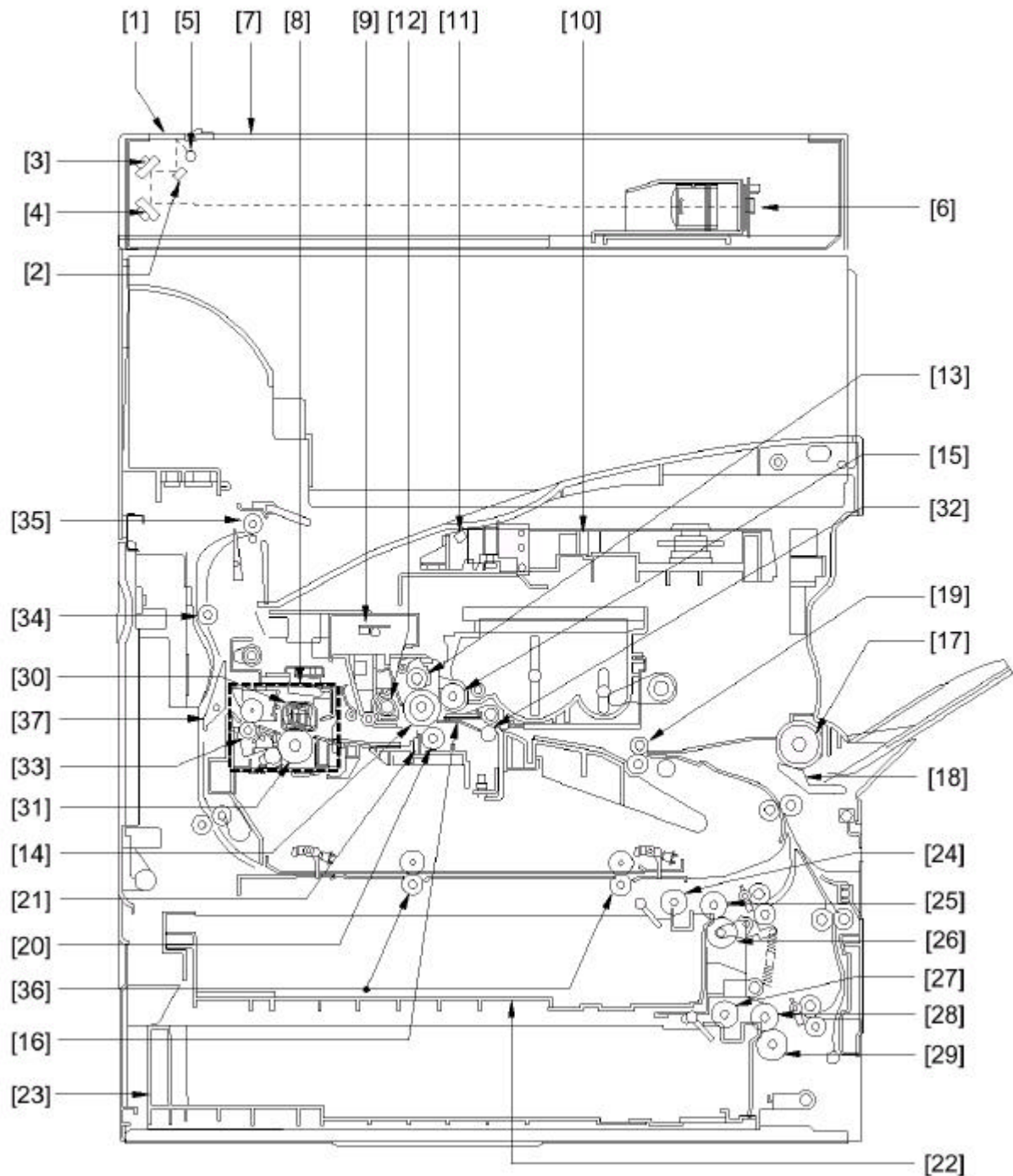

- |                                 |                                   |
|---------------------------------|-----------------------------------|
| [1] DADF reading glass          | [20] Transfer roller              |
| [2] No. 1 mirror                | [21] Static eliminator            |
| [3] No. 2 mirror                | [22] Cassette 1                   |
| [4] No. 3 mirror                | [23] Cassette 2                   |
| [5] Scanning lamp               | [24] Cassette 1 pickup roller     |
| [6] CCD unit                    | [25] Cassette 1 feeding roller    |
| [7] Copyboard glass             | [26] Cassette 1 separation roller |
| [8] Fixing assembly             | [27] Cassette 2 pickup roller     |
| [9] Pre-exposure lamp           | [28] Cassette 2 feeding roller    |
| [10] Laser unit                 | [29] Cassette 2 separation roller |
| [11] Laser mirror               | [30] Fixing film                  |
| [12] Drum cleaner assembly      | [31] Lower fixing roller          |
| [13] Primary charging assembly  | [32] Pre-transfer roller          |
| [14] Photosensitive drum        | [33] Fixing delivery roller       |
| [15] Developing cylinder        | [34] Outside delivery roller      |
| [16] Transfer guide             | [35] Delivery roller              |
| [17] Multifeeder pickup roller  | [36] Duplexing roller             |
| [18] Multifeeder separation pad | [37] Reversing frapper            |
| [19] Registration roller        |                                   |